

Q1. Drawing Board Has Many Parts. Its Battens Have A Purpose.

(a) to protect the board from twisting

(b) supporting the strip

(c) connecting the strip

(d) lay down on the table

ANSWER

Q2. The Part Of The Drawing Board On Which The T-Square Stock Slides Is Called ____.

(a) baton

(b) Strip

(c) Ebony Edge

(d) any

ANSWER

Q3. Which Quality Should Not Be In The Wood Used In The Drawing Board?

(a) soft wood

(b) well treated

(c) new knotted wood

(d) none

ANSWER

Q4. Measurement Of T-Square Is Taken

(a) by the length of the head

(b) the length of the blade

(c) by the width of the blade



(d) none of these

ANSWER

Q5. The Length Of T-Square Of T1 Size Is

(a) 1500mm

(b) 1000mm

(c) 700mm

(d) 500mm

ANSWER

Q6. Which Part Of The T-Square Slides On The Working Edge Of The Drawing Board?

(a) head

(b) Blade

(c) Ebony

(d) none

ANSWER

Q7. Select The Type Of Lines That Can Be Drawn Using Only "T" Square?

(a) straight parallel lines

(b) vertically parallel lines

(c) inclined parallel lines

(d) centered parallel lines

ANSWER

Q8. What Is The Angle Between The Head Of The T-Square And The Working Edge Of The Blade?



(a) 45 degrees

(b) 60 degrees

(c) 75 degrees

(d) 90 degrees

ANSWER

Q9. Which Of The Following Is Not A Use Of T-Square?

(a) Laying horizontal parallel lines

(b) Supporting the set square

(c) Working straight edge while cutting paper

(d) none

ANSWER

Q10. Identify The Side View Of The Below Isometric View. / Identify The Side View Of The Isometric View Given Below.

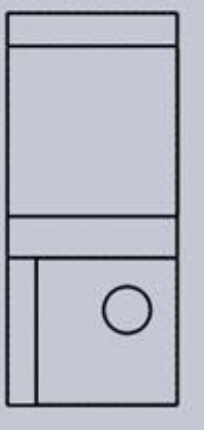
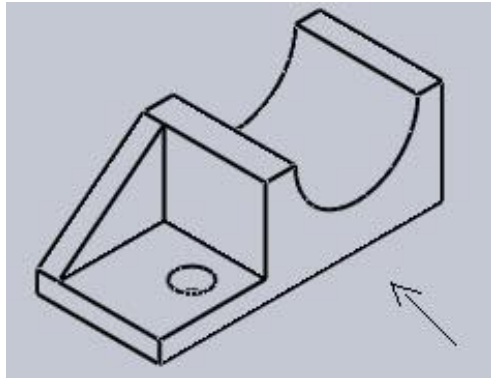

(a)

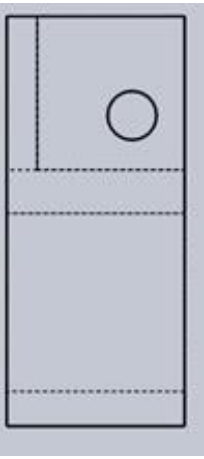

(b)

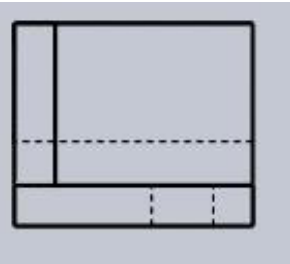

(c)

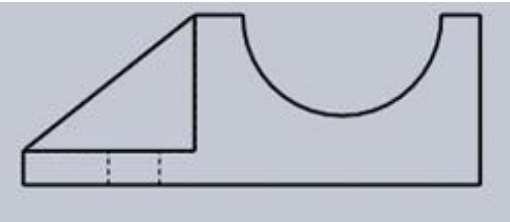

(d)

ANSWER

Q11. Lines Can Be Drawn In Multiples Of ____ Degree With The Help Of Square Only By Set Square.

(a) 15 degrees

(b) 30 degrees

(c) 45 degree

(d) 90 degrees

ANSWER

Q12. Protractor Is An Angle Measuring Instrument.

(a) angle in degrees

(b) angle in radians

(c) angle in minutes



(d) linear measure

ANSWER



Q13. How Accurately Can Angles Be Measured And Drawn With A Protractor?

(a) 1.5 degrees

(b) 0.5 degree

(c) 1 degree

(d) 2 degrees

ANSWER

Q14. What Work Can Be Done With A Protractor?

(a) measuring angles

(b) making an angle

(c) Making a sector by dividing a circle

(d. All of the above

ANSWER

Q15. Which Material Is Used To Make Protractor?

(a) wood

(b) Celluloid

(c) steel

(d) rubber

ANSWER

Q16. The Selection Of Pencil In Engineering/Technical Drawing Is Done On This Basis.





(a) length of pencil

(b) diameter of the pencil

(c) grade of pencil

(d) the color of the coin

ANSWER

Q17. Which Is The Hardest Grade Pencil?

(a) 7B

(b) HB

(c) 9H

(d) 2H

ANSWER

Q18. Several Grades Of Pencils Are Used To Draw Different Lines In Drawing. Low Grade Is Appropriate For Drawing Construction Lines.

(a) 2H or 3H

(b) HB or H

(c) H or 2H

(d) 8H or 9H

ANSWER

Q19. The Grade Of The Softest Pencil Is

(a) 6B

(b) HB

(c) 9H

(d) 5H



ANSWER

Q20. The Hardness Of The Lead Of The Pencil Depends On It.

(a) amount of kaolin

(b) the thickness of the coin

(c) amount of graphite

(d) length of pencil

ANSWER

1 2 3 4 5

Tags Engineering Drawing ITI Engineering Drawing Objective Question

Share :



< OLDER

NEWER >

You may like these posts

Show more

ITI Engineering Drawing Objective
Previous Year Question Paper 2022

🕒 June 25, 2022

👁 Read More

ITI Engineering Drawing Objective
Questions Paper All Trade ITI
Engineering Drawing MCQ pdf

🕒 June 25, 2022

👁 Read More

Engineering Drawing MCQ [Free
PDF] - Objective Question Part - 5

🕒 June 25, 2022

👁 Read More

ITI Engineering Drawing 1st year
Question Paper in Hindi Part - 4

🕒 June 25, 2022

👁 Read More

🗨 Post a Comment

0 Comments

* Please Don't Spam Here. All the Comments are Reviewed by Admin.